

Mer-Krete™ Tuff-Flex 442

HIGH STRENGTH FLEXIBLE THIN-SET ADMIX

Designed Specifically For Use With Vitreous Materials

DESCRIPTION:

Tuff-Flex 442 is a compounded and stabilized latex emulsion for use with Mer-Krete Thin-Sets. The resultant mortar is notched troweled to form a thin mortar bed for porcelain, granite, quarry and glass mosaic, stone and other hard to set materials. When cured these mortars display excellent physical properties in adhesion, resiliency, water and weather resistance, and exceed ANSI A-118.4 requirements.

USE:

For setting porcelain, quarry, granite, stone, glass mosaics and other materials requiring a high strength mortar. Tuff-Flex 442 develops a strong bond to all common substrates (concrete, masonry, wallboard and plaster) and is ideal for vertical veneers both interior and exterior.

ADVANTAGES:

- Superior bond strength
- Highly flexible
- Adheres to all common sound substrates
- Non-shrinking
- Non-toxic and non-flammable
- Water resistant – will not bleed

LIMITATIONS:

- Cannot be applied or stored in freezing weather. After installation, however, this mastic has excellent resistance to frost damage (freeze-thaw cycling).
- Consult manufacturer for installations over wood.

CONSIDERATIONS FOR INSTALLATION:

No sealers, curing compounds or coatings shall be used on the substrate. Surfaces shall be left clean. Any contaminants shall be removed prior to application.

The use of back-mounted ceramic or mosaic sheets shall not be permitted for exterior installation, wet areas or swimming pools.

Spread only as much mortar as can be covered while the surface is still tacky. Dusty or dry concrete surfaces should be washed with clean water just prior to commencing work and left uniformly damp (no standing water).

Patching, leveling or areas requiring a mortar bed should be prepared using Underlay-L System.

INSTALLATION:

Work should be performed only by a trained applicator familiar with these products and in strict accordance with manufacturer's application specifications, abbreviated below:

The proportions of the mix depend on the temperature and humidity. Higher temperatures and drier humidities will require slightly more latex to reach optimum spreading consistency. Generally 1½ gallons of liquid will wet out one 50 lb. sack of thin-set.

1. When heavier fills are required, use Underlay-L or Underlay-M System. Consult manufacturer.
2. Consult current TCA manual for expansion joint recommendations.
3. Grout or point all joints using a prepared grout mixture blended with 150 Acrylic Latex to bring the mix to a workable consistency.

AVAILABILITY:

Mer-Krete Systems are installed by trained contractors located in several population centers in the U.S.

Mer-Krete Systems
501 Van Ness Avenue
Torrance, California 90501

Tel: (323) 775-2461
Fax: (310) 320-4938
Internet: www.merkrete.com
E-mail: info@merkrete.com

For the latest and most current product information, make sure to visit our website at: www.merkrete.com

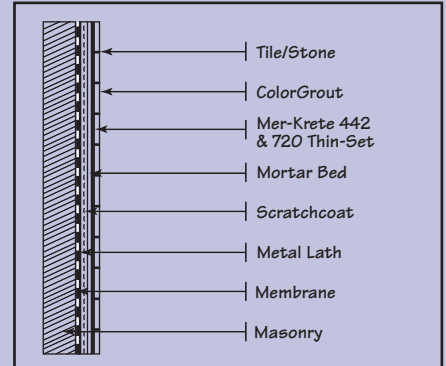

PHYSICAL & TECHNICAL DATA:

Adhesion in Shear: (ANSI A-118.4)
48 Hours >200 p.s.i.
28 Days >450 p.s.i.

Compressive Strength: >4000 p.s.i.
(28 Day)

Linear Shrinkage: None

Water Absorption: <4%

Temperature Sensitivity:
Low Range 45°F
High Range 100°F

Exceeds ANSI A-118.4 Standards

TECHNICAL ASSISTANCE:

Specification assistance is highly recommended prior to a proposed installation. Contact any Mer-Krete technical representative for recommendations.

WARRANTY:

5 year, 10 year and Limited Lifetime warranties are available. Contact the Customer Service Department for specific warranty information.



MER-KRETE SYSTEMS
(800) 851-6303

A Division of **PareXLahabra**

REV 7/07