

# Mer-Krete™ 200 Latex and 211 Filler

## MULTI PURPOSE POLYMER MODIFIED PORTLAND CEMENT FLEXIBLE MORTAR

### 1. PRODUCT NAME

#### 200 Latex and 211 Filler

Multi Purpose Polymer Modified Portland Cement Flexible Mortar

### 2. MANUFACTURER

Mer-Krete Systems  
501 Van Ness Avenue  
Torrance, CA 90501  
PH (323) 775-2461  
FAX (310) 320-4938  
(800) 851-6303  
www.merkrete.com

### 3. PRODUCT DESCRIPTION

#### BASIC USE

**Mer-Krete 200 Latex and 211 Filler** is a two component superior grade polymer modified Portland cement flexible thin-set mortar for installing ceramic tile and natural stone. This mortar system displays excellent physical properties in adhesion, resiliency, water resistance, and shock and weather resistance. It has had excellent results when used for demanding exterior façade installations. It is recommended for use in the thin-set installation method for absorptive, semi-vitreous, vitreous, porcelain and glass tile over properly prepared masonry, concrete, and cement backer board. In dry areas, it is suitable for gypsum board.

#### USES

**200 Latex and 211 Filler** are available in either gray or white powder, and suitable for residential and commercial construction in interior and exterior applications. **200 Latex and 211 Filler** is designed for wall and floors consisting of the following substrates:

#### ADVANTAGES

Shock resistance  
Freeze thaw stable  
Interior and exterior  
CTIOA Tested Material  
Bonds to most surfaces  
Available in both gray and white colors  
Increased flexibility and shock resistance  
Superior adhesion for porcelain and glass tile.  
Ideal for demanding exterior veneer installations  
Exceeds ANSI A 118.4 for Latex Portland Cement Mortar.

#### SUITABLE SUBSTRATES

Concrete	Concrete Masonry
Cement Mortar Beds	Cement Plaster
Ceramic Tile and Stone	Brick Masonry
Cement Backer Board**	Cement Terrazzo
Gypsum Wallboard*	Cutback Adhesive***

Post tension construction

\*Interior Use Only

\*\* Consult cement backer board manufacturer for installation recommendations and to verify acceptability for exterior use.

\*\*\* Consult Mer-Krete Technical Department

#### LIMITATIONS

Do not use **200 Latex and 211 Filler** below 40°F (4°C) or above 95°F (35°C). Use caution; do not allow mortar to freeze for the first 72 hours. Do not soak tiles previous to installation. **200 Latex**

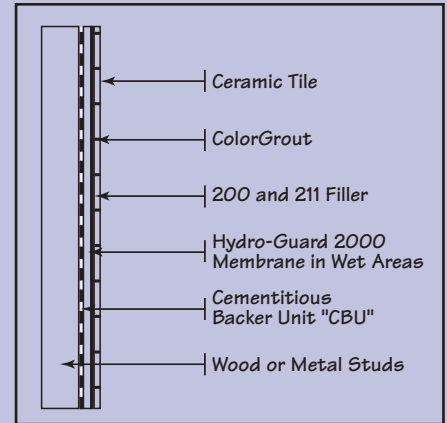

#### PHYSICAL & TECHNICAL DATA:

<b>Adhesion in Shear:</b>	(CTI-64-1)
48 Hours	
Vitreous Material	> 230 p.s.i.
Non-Vitreous Material	> 350 p.s.i.
28 Days	
Vitreous Material	> 450 p.s.i.
Non-Vitreous Material	> 600 p.s.i.
<b>Compressive Strength</b>	> 4000 p.s.i.
(28 Day)	
<b>Linear Shrinkage:</b>	None
<b>Water Absorption:</b>	< 4%
<b>Temperature Sensitivity:</b>	
Low Range	45°F
High Range	100°F

#### TECHNICAL ASSISTANCE:

Specification assistance is highly recommended prior to a proposed installation. Contact any Mer-Krete technical representative for recommendations over existing substrates or problem areas.



**MER-KRETE SYSTEMS**  
**(800) 851-6303**

A Division of **PareXLa**habra

**Mer-Krete Systems**  
501 Van Ness Avenue  
Torrance, California 90501

Tel: (323) 775-2461  
Fax: (310) 320-4938  
Internet: [www.merkrete.com](http://www.merkrete.com)  
E-mail: [info@merkrete.com](mailto:info@merkrete.com)

For the latest and most current product information, make sure to visit our website at: [www.merkrete.com](http://www.merkrete.com)

REV 7/07

# Mer-Krete™ 200 Latex and 211 Filler

## MULTI PURPOSE POLYMER MODIFIED PORTLAND CEMENT FLEXIBLE MORTAR

**and 211 Filler** must not be used to apply over asphalt sheeting, vinyl covered wall board, Masonite®, cement asbestos board, metal, glass, plastic, or other unstable substrates. Improperly cured or wet plywood, particle board or strip wood are not suitable substrates. Installations that will be continually wet like swimming pools, fountains and gang showers, the completed installation should be cured a minimum of 14 days and allowed to dry before exposure to water. For white or light colored marbles use **200 Latex and 211 Filler** White powder. Some dimensional stone tile like green and red marbles may warp when installed with water based setting materials. These water sensitive stone tiles should be installed with **Mer-Krete ProEpoxy**. For use of **200 Latex and 211 Filler** over additional substrates or situations not mentioned in these instructions, contact Mer-Krete's Technical department.

### 4. TECHNICAL DATA

#### APPLICABLE STANDARDS

**Mer-Krete's 200 Latex and 211 Filler** meets or exceeds industry requirements ANSI A118.4 for Latex Portland Cement Mortar. CTIOA tested Material. Follow ANSI A108.5 for installation.

<b>Mer-Krete 200 Latex</b>	<b>Mer-Krete 211 Filler</b>
<b>COLORS</b> White	<b>COLORS</b> Gray and White
<b>PACKAGING</b> 5 gal. bucket	<b>PACKAGING</b> 50 lb. (22.7 kg.) bag

### 5. INSTALLATION

#### SURFACE PREPARATION

All surfaces must be between 40°F (4°C) to 95°F (35°C) and structurally sound (deflection not to exceed 1/360 of the span), dry clean and free from oil, grease, wax, paint, old adhesives, sealers and curing compounds. Any contaminates which inhibit proper bond must be removed. Substrate preparation should be completed following ANSI A108 AN-2 "General Requirements for Sub-surfaces". All substrates should be plumb and true, surface deviation should not exceed 1/4" in 10'. Patching, leveling or areas requiring a mortar bed should be prepared using Mer-Krete's Underlayments. Movement (Expansion) joints should be provided to comply with TCA method EJ 171.

#### Cement Substrates

All concrete substrates should be cured a minimum of 28 days. Smooth steel troweled floors should be roughed up using mechanical chipping, scraping or shot blasting. Dampen porous or dry concrete previous to installation of tile. Do not leave puddles or standing water.

#### Cement Backer Board

Follow cement board manufacturer's instructions.

#### MIXING

In a clean container, add approximately 5 quarts (4.7 liters) of Mer-Krete Latex 200 krete liquid. Then add the contents of the 50 lb. (22.7 kg) 211 Filler powder. Mix thoroughly by hand or with a slow speed mixer to a smooth, thick, trowelable consistency. Allow mortar to slake for approximately 15 minutes, and then remix before using. Remix without adding additional water or powder. Mortar consistency shall be such that when applied with the recommended notched trowel to the substrate, the ridges formed in the mortar do not flow or slump. During use, stir mortar mix occasionally. Do not temper with additional liquid.

#### APPLICATION

Apply mortar to the substrate with the flat side of the trowel, with enough pressure to firmly work into the surface. With a notched trowel, immediately follow with a heavier coat of material using the appropriate trowel and enough mortar to provide 100% coverage to the back of the tile. Some extruded or lug back tiles back-buttering of tiles may be required. Do not spread more mortar than can be covered in 20 minutes or before the mortar skins over. It is advised that during the installation, remove a tile to insure the mortar has not skinned over and check the tile and substrate mortar coverage. Comb the mortar using an appropriate notched trowel in one direction.

**Mer-Krete Systems**  
501 Van Ness Avenue  
Torrance, California 90501

Tel: (323) 775-2461  
Fax: (310) 320-4938  
Internet: [www.merkrete.com](http://www.merkrete.com)  
E-mail: [info@merkrete.com](mailto:info@merkrete.com)

**MER-KRETE SYSTEMS**  
**(800) 851-6303**

A Division of **PareXLahabra**

For the latest and most current product information, make sure to visit our website at: [www.merkrete.com](http://www.merkrete.com)

REV 7/07



# Mer-Krete™ 200 Latex and 211 Filler

## MULTI PURPOSE POLYMER MODIFIED PORTLAND CEMENT FLEXIBLE MORTAR

Place tiles in mortar, slide back and forth perpendicular to the ridges (NTCA "Trowel and Error" method) to insure proper coverage. Do not adjust tiles set in mortar after 15 minutes.

### CLEANING

Water is all that is needed to remove any uncured mortar from tiles, tools and equipment.

### 6. AVAILABILITY

**Mer-Krete 200 Latex and 211 Filler** is available at leading tile houses and construction distributors. Contact Mer-Krete for the name of the nearest dealer.

### 7. WARRANTY

5 year, 10 year and Limited Lifetime warranties are available. Contact Mer-Krete technical department for specific warranty information. Mer-Krete Systems warrants that this product meets applicable ANSI standards in force at the time of manufacture. Mer-Krete will replace any product which proves defective due to quality of ingredients used or due to the manufacturing process itself. The warranty shall apply only if the product is installed and used strictly in accordance with applicable industry standards, specifications, and instructions provided by Mer-Krete. Mer-Krete shall not be liable for misapplication, misuse or abuse of the product, application or other event outside of its control. Replacement of defective product or, at Mer-Krete's option, refund of the price of product of any defective item shall be the buyer's sole remedy under this warranty. Mer-Krete shall in no event be liable for any damages in excess of the purchase price of the defective product. MER-KRETE SHALL IN NO EVENT BE LIABLE FOR ANY CONSEQUENTIAL, INCIDENTAL OR SPECIAL DAMAGES.

This warranty constitutes the sole and exclusive warranty given by Mer-Krete Systems in connection with this product, and Mer-Krete Systems has authorized no person to make or give any other warranties, or representations, oral or written, on its behalf. IN PARTICULAR, THERE ARE NO IMPLIED WARRANTIES, INCLUDING WITHOUT EXCEPTION, WARRANTIES, MERCHANTABILITY OR FITNESS FOR A PARTICULAR PURPOSE. No modification of this warranty in favor of any buyer shall be valid unless given in writing and signed by an officer of Mer-Krete Systems.

### 8. MAINTENANCE

None required, but installation performance and durability may depend on properly maintaining products supplied by other manufacturers.

### 9. TECHNICAL SERVICES

Mer-Krete Systems maintains technical field representatives available throughout the country. Call (800) 851-6303 for the nearest representative.

### 10. FILING SYSTEMS

Mer-Krete Architectural Product Catalog and CD Rom.

[www.merkrete.com](http://www.merkrete.com)

**Mer-Krete Systems**  
501 Van Ness Avenue  
Torrance, California 90501

Tel: (323) 775-2461  
Fax: (310) 320-4938  
Internet: [www.merkrete.com](http://www.merkrete.com)  
E-mail: [info@merkrete.com](mailto:info@merkrete.com)



**MER-KRETE SYSTEMS**  
**(800) 851-6303**

A Division of **PareX**Lahabra

*For the latest and most current product information, make sure to visit our website at: [www.merkrete.com](http://www.merkrete.com)*

REV 7/07